

103E7

User Instructions



Your 103E7 timeswitch will control your hot water and central heating system automatically, turning the system on and off at the times you have programmed.

Before beginning programming, you should reset the unit. Open the flap on the front of the clock. Press and hold **+1hr** and **MAN** buttons, then press and release the reset button using a small non-metallic object, finally, release the **+1hr** and **MAN** buttons. This will reset the unit and re-instate all preset programmes. (Fig. 1)

Fig. 1

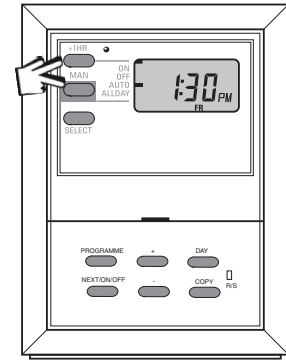

1. Setting the time and date

Press and hold **PROGRAMME** for 5 seconds to display year – use the **+** and **-** buttons to set the correct year.

Press **DAY** to display the day and month – use **+** or **-** buttons to set the correct month (1=Jan. 2=Feb etc)

Press **DAY** to set the correct day – use **+** or **-** button to set the correct day.

Press **PROGRAMME** to display the time (**SET TIME** will flash in the display) (Fig.3)

Use the **+** or **-** buttons to set the correct time.

Press **PROGRAMME** to return to RUN mode.

Fig. 2

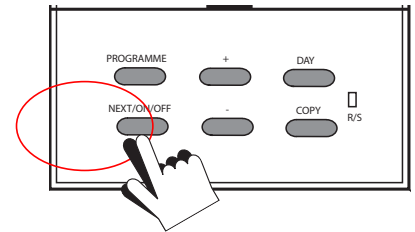

Fig. 3



Fig. 4

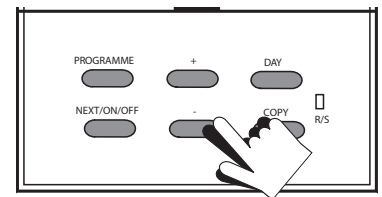

Fig. 5

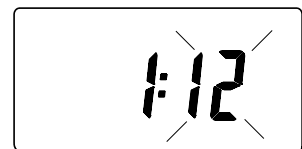
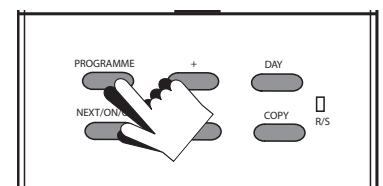

Fig. 6



2. Programming the Hot Water and Central Heating - 7 day mode

You can programme your central heating and hot water to come on and go off up to 3 times per day to suit your requirements.

1. Press the **PROGRAMME** button until **SET ON TIME** appears at the top of the display, press **DAY** until **MO** appears at the bottom, (Fig.4)
2. Use the **+** or **-** buttons to the first time you want your heating to come on.
3. Press **NEXT ON/OFF** to move to the next event and set your **OFF** time using the **+** or **-** buttons. (Fig.4)
4. Repeat step 2 for the next 2 sets of **ON/OFF** times
5. Press **DAY** to move to the next day.
6. To copy the same times from the previous day, press **COPY** (Fig.5)
7. To set different times, repeat steps 2 -5
8. Once you are happy with your settings, press **PROGRAMME** to return to the **RUN** mode. (Fig.6)

N.B. If you do not press a button at all for 3 minutes the unit will automatically return to **RUN** mode.

3. Programming the Hot Water and Central Heating - 5/2 day mode

You can programme your central heating and hot water to come on and go off up to 3 times per day to suit your requirements.

1. Press the **PROGRAMME** button until **SET ON TIME** appears at the top of the display, press **DAY** until **MOTUWETHFR** appears at the bottom (Fig. 7)
2. Use the **+** or **-** buttons to the first time you want your heating to come on.
3. Press **NEXT ON/OFF** to move to the next event and set your **OFF** time using the **+** or **-** buttons.
4. Repeat step 2 for the next 2 sets of **ON/OFF** times
5. Press **DAY** to change to weekend days, **SASU** will appear at the bottom of the display.
6. To set, repeat steps 2 -4
7. Once you are happy with your settings, press **PROGRAMME** to return to the **RUN** mode.

N.B. If you do not press a button at all for 3 minutes the unit will automatically return to **RUN** mode.

4. Programming the Hot Water and Central Heating -Manual Mode

MANUAL

- Press the **MAN** button to manually override the programme (only if unit is in **AUTO** or **ALLDAY** mode) – If the system is OFF it will come on, and if it is on it will go OFF – normal operation will resume at the next timed event
- To cancel the override press **MAN** again. (**Fig. 8**)

Fig. 7

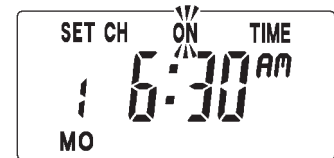

Fig. 8

Override buttons

